



# System Diagram Workshop

## Hijend Hotel Chilled Water System Evaporator Pump Loop Exercise



Presented By:  
David Sellers

Senior Engineer, Facility Dynamics Engineering

# Adding the Evaporator Pump Loops

The field sketch provided for this exercise depicts the distribution loop portion of the Hijend Hotel chilled water system in the central plant

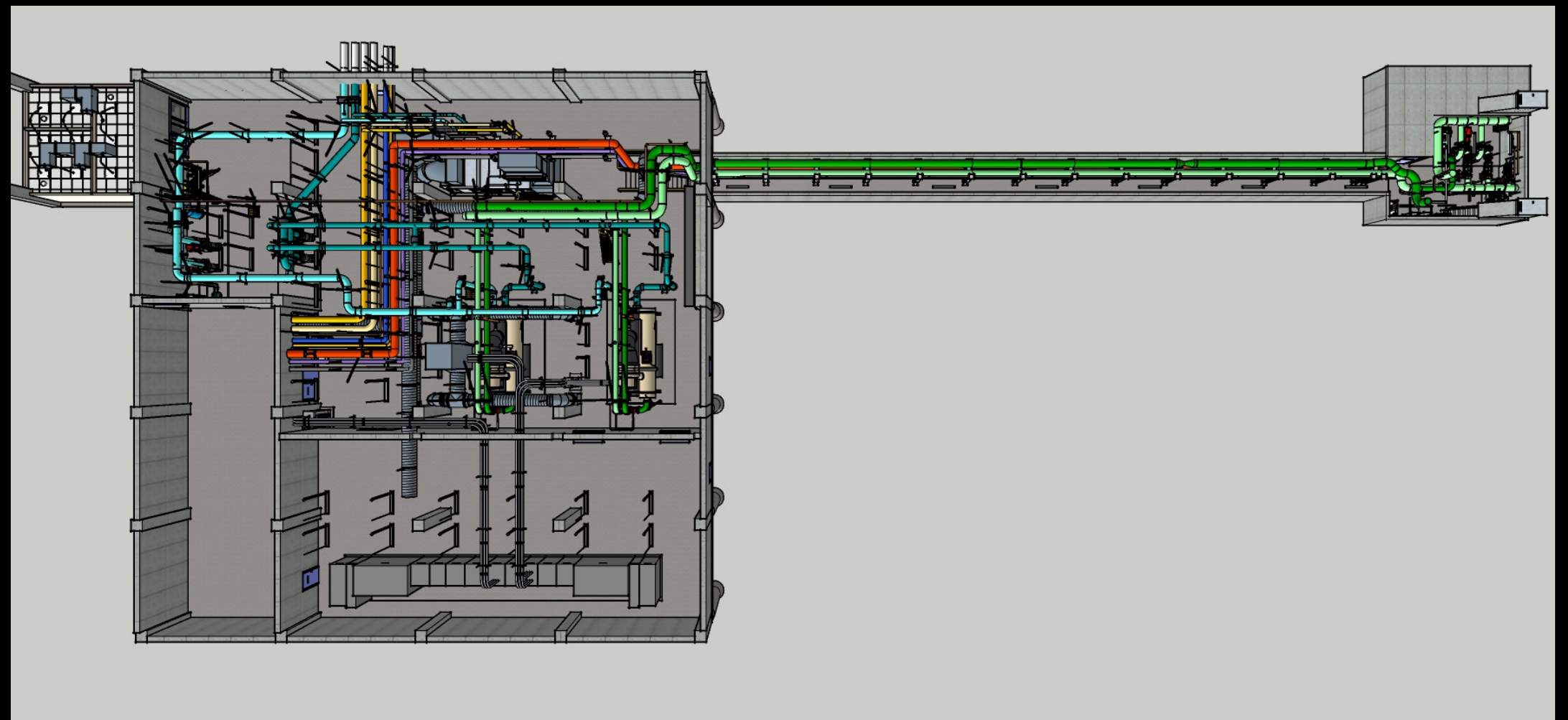

# Adding the Evaporator Pump Loops

Given:

- A field sketch of the distribution pumping loop portion of the Hijend Hotel chilled water system (following slide)
- The 3DVista model of the plant at this link:

<https://tinyurl.com/PECSysDgmAddEvapPump>



Do the Following

1. Add the evaporator pump circuits serving chillers 1 and 2 to the diagram

# The Distribution Loop

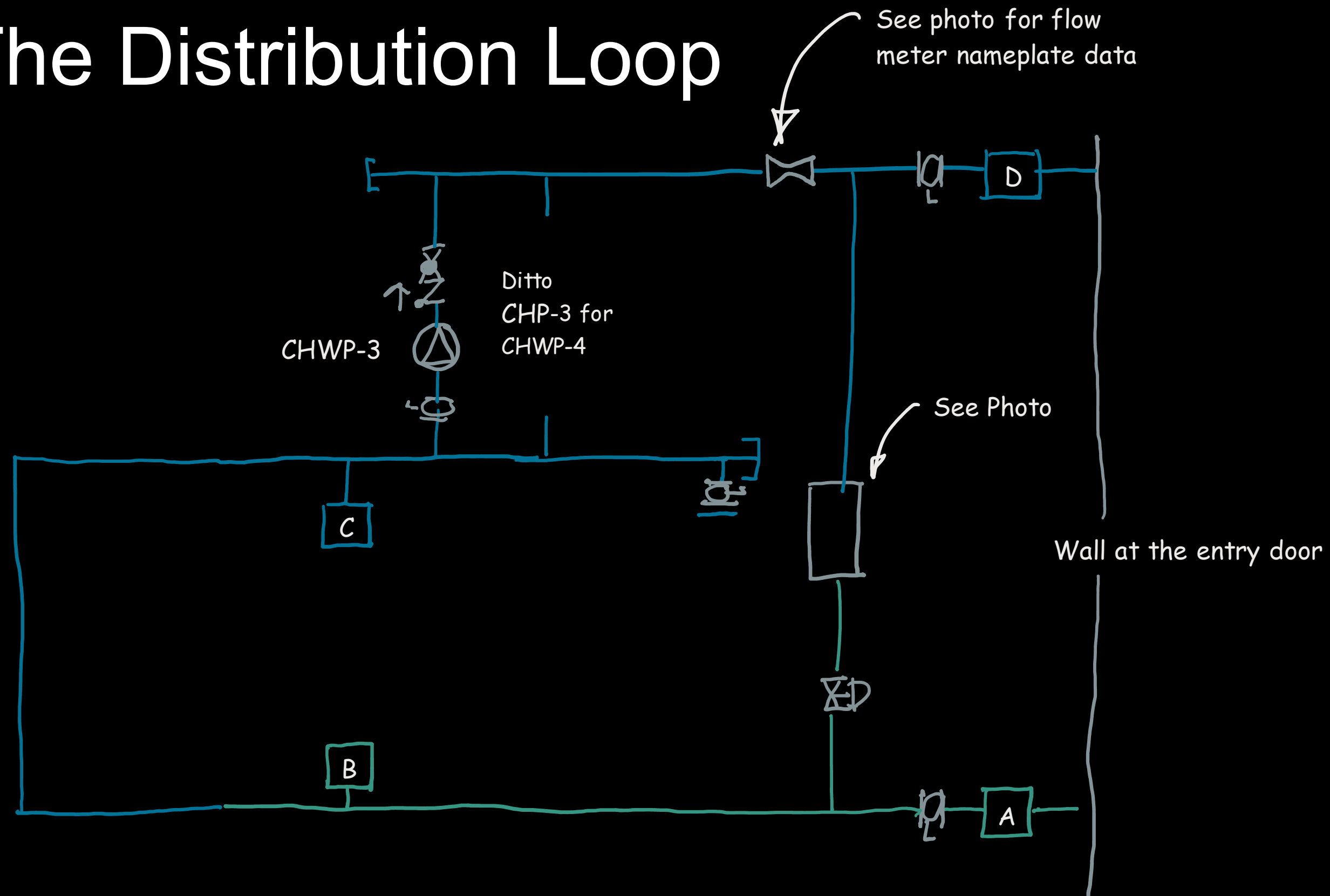

# The Distribution Loop

